

SHACKLES

Bow and 'D' screw pin shackles up to 120 tonne SWL

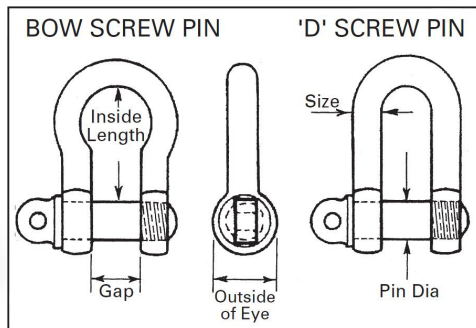
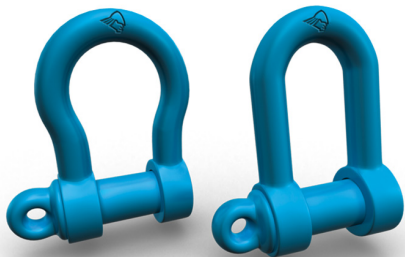

Size (mm)	Pin dia (mm)	Gap (mm)	O/dia eye (mm)	Inside length (mm)	Weight safety (kg)	Weight screw pin (kg)
13	16	19	32	48	0.36	0.36
16	19	26	41	61	0.72	0.68
19	22	32	48	70	1.3	1
22	25	35	54	83	1.8	1.5
25	29	42	60	95	2.6	2.4
29	32	45	67	108	3.6	3.4
32	35	51	76	118	5.1	3.9
35	38	57	85	133	6.9	5.9
38	41	60	92	149	9	7.9
44	51	73	111	178	14.2	12.7
51	57	83	127	197	21	18.7
64	70	105	152	267	43	38
76	83	127	165	330	66	59
89	95	140	203	381	114	102

All dimensions are approximate

Bow and 'D' safety pin shackles up to 100 tonne SWL

2.33

SWL tonnes	Size (mm)	Pin dia (mm)	Gap (mm)	O/dia eye (mm)	Inside length (mm)	Weight screw pin (kg)	Weight screw pin (kg)
2	13	16	19	32	41	0.36	0.3
3.25	16	19	26	41	51	0.67	0.55
4.75	19	22	32	48	60	0.72	0.6
6.5	22	25	35	54	70	1.7	1.4
8.5	25	29	42	60	80	2.4	2.1
9.5	29	32	45	67	89	3.3	3
12	32	35	51	76	99	4.7	4.1
13.5	35	38	57	85	111	6.1	5.5
17	38	41	60	92	124	8.4	7.4
25	44	51	73	111	149	13	16
35	51	57	83	127	171	19	16.5
50-55	64	70	105	152	203	38	33.7
75-85	76	83	127	165	229	56	49
100	89	95	149	203	267	99	86

All dimensions are approximate