

MOORLINK BALL SWIVEL

2.24

MoorLink's compact multi-functional Ball Swivels combines a wire socket, swivel and chain connector in one very simple unit. The device is designed to avoid damage to the wire during disconnection of the combined wire/chain system, absorbing the torque built up in the wire. The units are built in forged or cast grade 4 steel and CNC machined to final dimension. This method makes it very easy to tailor make the outer geometry to suit different fairlead sheaves.

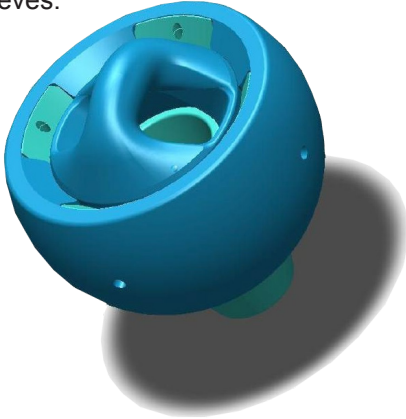

Type	134	189	200
A (mm)	90	83	94
B (mm)	152	149	184
C (mm)	355,6	333	394
D (mm)	558,8	426,8	558,8
E (mm)	481	474	508
L (mm)	575	562	610
Mbl (kN)	6450	6085	7950

All dimensions are approximate

